

To determine the correct length of hose, subtract the cut-off factor for each end fitting from the overall length of assembly.

## Field attachable

100 'B' series Barb-Tite

### 100 'B' series Barb-Tite

**CAUTION** Sealing integrity may be damaged by the use of clamps.

**Ordering information:** Order individually by part number.

Refer to important safety information on pages A-2.

**Application:** Low pressure shop or service air lines. Often used for low pressure lube and oil lines.

**Compatible hose:** H100, H101, H201, H332, 35FH

**Pressure:** Determined by maximum working pressure for hose size. See pages A-24-25 for working pressure ratings for hose end configurations.

**Material:** CA360 brass

**WARNING:** California Proposition 65, see page A-2.

**Advantages:** Easy to assemble – just push the fitting into the hose. No clamps needed! Low cost and a wide selection of configurations and sizes.

**Assembly instructions:**

1. Lubricate\* insert.
2. Hold hose at angle as shown and push on and up over first barb.
3. Continue to push straight on until hose is seated under protective plastic cap. (Keep hand back from hose end area so that hose can expand.)

\* Eaton Assembly Lubricant  
222070-8 - 1 gallon plastic jug  
222070 - 1 pint plastic squeeze bottle

**Disassembly instructions:**

1. Split hose as shown. Do not cut completely through hose. Sealing edge of barb could be damaged.
2. Bend hose and remove with quick pull.

**Assembly equipment:** See pages L-26 and L-60 for optional Assembly Tools.

**Label set:** FS-500

**Note:** Refer to current price list for availability of cataloged items. Configurations and dimensions subject to change without notice.

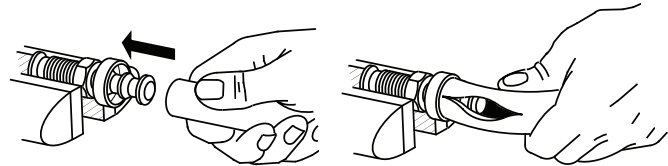

#### Male pipe rigid

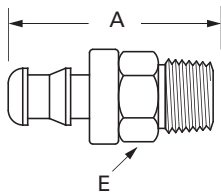

Hose I.D.	Pipe size	Part number	Thread size	A	Hose cut-off factor	Hole dia.	Hex E
1/4	1/8	10004B-102	1/8-27	1.29	.65	.172	7/16
1/4	1/4	10004B-104	1/4-18	1.52	.88	.172	9/16
5/16	1/8	10005B-102	1/8-27	1.36	.69	.234	1/2
5/16	1/4	10005B-104	1/4-18	1.57	.87	.234	9/16
3/8	1/8	10006B-102	1/8-27	1.46	.69	.297	1/2
3/8	1/4	10006B-104	1/4-18	1.65	.88	.297	9/16
3/8	3/8	10006B-106	3/8-18	1.65	.88	.297	11/16
1/2	3/8	10008B-106	3/8-18	1.85	.94	.391	11/16
1/2	1/2	10008B-108	1/2-14	2.10	1.19	.391	7/8
5/8	1/2	10010B-108	1/2-14	2.60	1.19	.484	7/8
3/4	3/4	10012B-112	3/4-14	2.66	1.25	.609	1-1/16
1	1	10016B-116	1-11 1/2	3.08	1.45	.85	1-3/8

#### SAE 45° flare male rigid

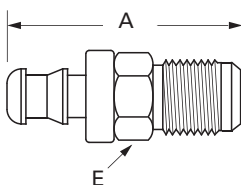

Hose I.D.	Tube size	Part number	Thread size	A	Hose cut-off factor	Hole dia.	Hex E
1/4	1/4	10004B-304	7/16-20	1.45	.81	.172	7/16
1/4	5/16	10004B-305	1/2-20	1.54	.94	.172	1/2
5/16	5/16	10005B-305	1/2-20	1.60	.94	.220	1/2
3/8	3/8	10006B-306	5/8-18	1.73	1.00	.297	5/8

**Note:** Drawings may differ from actual parts.